

EAGLE MAST ARM TWO-WAY SUSPENSION (IRON) BULLETIN 2304

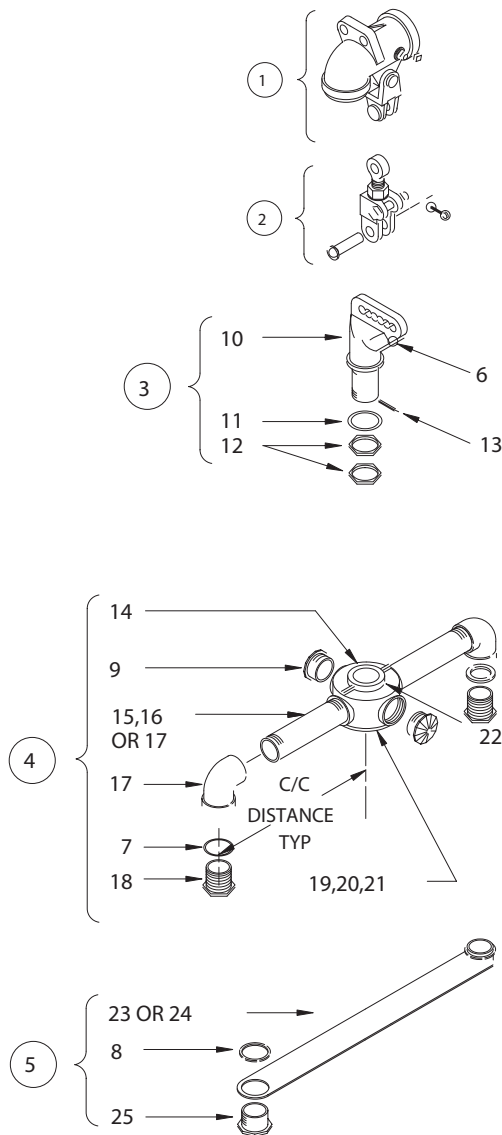

ITEM	DESCRIPTION	PART NO.
①	MAST ARM FITTING ASSEMBLY	A32524
②	BALANCE ADJUSTER	A32000
③	MULTI-WAY WIRE ENTRANCE	A32125
④	2-WAY TOP BRACKET ASSEMBLY	
	ON 8.5 INCH C/C	U3221B
	ON 10.5 INCH C/C	U3221D
⑤	2-WAY BOTTOM BRACKET ASSEMBLY	
	ON 8.5 INCH C/C	L2201B
	ON 10.5 INCH C/C	L2201D
6	BUSHING	M10738
7	NEOPRENE WASHER	M60615
8	CONDUIT NUT	M30244
9	ORNAMENT CAP	M20816
10	WIRE ENTRANCE	M32142
11	LEAD WASHER	M81743
12	LOCKNUT	M30244
13	COTTER PIN (5/32)	M50553
14	4-WAY HUB CENTER	M34767
15	PIPE ARM FOR 8.5 C/C	A7020490550
16	PIPE ARM FOR 10.5 C/C	P361050
17	ELBOW, SERRATED	M31112
18	LOCKNIPPLE	M32272
19	COVER	M23332
20	SCREW (3/8-16)	M50134
21	LOCK WASHER	M51780
22	SET SCREW (1/4-20)	M50131
23	TIE BRACE FOR 8.5 C/C	M24472B
24	TIE BRACE FOR 10.5 C/C	M24472D
25	ORNAMENT CAP	M20872
26	SERRATED RING	M20466
27	SET SCREW	M50360
28	FLAT WASHER	M30473

*Bulletin 2304x

*x = "B" for 8½" C/C distance
 x = "D" for 10½" C/C distance